

IDLE 花香藝術館

Innovation Design Life Education Flower Museum

2021 Annual Report



# Content

Wild Rose Story

野玫瑰之頌

Annual Review

花香事紀

Introduction IDLE Social  
Enterprise

花香藝術館簡介

Services in Hong Kong

香港服務

Overseas Services in Nepal

海外服務

Financial Report

財務報告

Acknowledged

鳴謝

Staff

職員



A vertical calligraphy scroll with the characters '安住當下' (Anzhu Dangxia) written in bold, black ink. The scroll is set against a background of soft, painterly green and blue washes. A small red seal is visible at the bottom left of the scroll.

# 安住當下

## 野玫瑰之頌

這一年來，疫情帶來了許多沈澱與反思的空間，讓我們得以重新思考人與自然、與萬物的關係。「花香」一直在自然藝術中探索、思考著何謂「藝術療癒」。2021花香在香港《坪洲療癒之島》成立ArtEco，我們規劃了這趟走入坪洲山林的「靜心六道及翳化藝療癒之旅」。拜訪被遺忘的血桐，踩進土地、踏入森林，將藝術療癒為實際可行的體驗，邀請您透過眼、耳、鼻、舌、口，五感身聲，在海洋、森林環繞下，實際感受香港坪洲療癒之島的療癒魅力。

藝術療癒之旅不但是美感教育，也是生命教育，我們總希望參加者藉著芳香、藝術療法的引動，來培養敏銳的感受與覺察力，並建立起欣賞美的能力；也期待參加者在上完課之後，能換個角度來面對周遭環境與困難的生命處境，同時感染給身旁的人——我們相信，只要這個城市的角落裡多一個默默綻放著藝術香氣的人，世界就會多一分希望。

A vertical calligraphy scroll with the Chinese characters '安住當下' (Anzhu Dangxia) written in black ink. The scroll is set against a background of soft, blended green and blue colors. A small red seal is visible at the bottom left of the scroll.

安住當下

## Wild Roses

In the past year, the epidemic has brought for reflection, Let us to rethinking the relationship between human and nature. We has been inspiring about the "Art of healing" in nature art.in 2021, Idle enterprise established ArtEco in Hong Kong's "Island of Healing in Peng Chau", and we hold an meditation and healing journey at Peng Chau. We walk by walk in the forest, through the five senses of the body sounds, surrounded by the ocean and the forest.

The art healing journey is not only aesthetic education, but also life education, we always hope that participants will cultivate feelings and awareness through the our programe and art therapy, and build the ability to appreciate beauty; We also expect that the participants will be able to face the surrounding environment and difficult life situation from a different perspective in our life. There is only one corner of the universe you can be certain of improving, and that's your own self awareness

## **Establishment**

After the Sichuan earthquake in 2008, more than 710,000 adolescents were arranged to live in orphanages in local welfare homes. This disadvantaged group lacked basic livelihood knowledge and skills and badly needed appropriate vocational training for them. A group of Hong Kong social workers who had participated in the earthquake relief and post-disaster reconstruction work in that year, with the spirit of gratitude, dedication and care, and with the promotion of three hearts (enthusiasm, love and confidence) and two Beliefs (beliefs and creative ideas), set up the IDLE Flower Art Museum in March 2012 to service the rural residents affected by the earthquake.

## **Purpose**

We have the spirit of happiness, gratitude, dedication and care, We also awaken and cultivate social conscience, and promote sustainable and valuable social enterprises.

## **Our Service boardies and Targets**

We mainly serve the urban areas of Gumdi in Chuchepai and D hading, Laprak, Kathmandu Nepal. There are affected by the earthquake and support women in rural And family.

The main service groups are orphans and single-parent children, students, women and the elderly. Our Service target have children, students, adults and the elderly. Among them, college students are our main support force.

## 成立

2008年四川地震後，被安排住進當地福利院孤兒學校的青少年人數超過71萬，這一群災後的弱勢組群缺乏基本的謀生知識及技能，極需社會為他們提供適當的職業培訓。一群曾參與當年地震救災及災後重建工作的香港社工，懷著感恩、奉獻、關懷的精神，在三心(熱心、愛心及信心)二念(信念和創意理念)的推動下，於2012年3月成立「IDLE花香藝術館」社會企業，為受地震災害影響的山區居民開展服務。

## 信念

宣揚「以藝術燃亮生命，用情意溫暖人心」的信念。

## 宗旨

懷抱惜福、感恩、奉獻、關懷的精神，發揮私營和公營機構這兩個領域的優勢，喚醒和培養社會良心，推動可持續的、有價值的社會企業。

## 我們的服務 地區及對象

南亞國家尼泊爾加德滿都市區 Chucheptai 及 (Dhading) 裡的 Gumdi ,Laprak 受地震影響及山區的女性們及家庭。

主要服務的人群為孤兒和單親兒童、學生、婦女、老人。

參與我們的人群涵蓋各個階層，包括小孩、學生、成年人、老人。其中，大學生是

我們的主要支援力量

## Our Service (Hong Kong)

Item	Result
<p>ArtEco Mindfulness Workshop 靜心工作坊( 靜心六道及翳,化,藝)</p>	<p>The purpose of the Mindfulness workshop is to expect each participant to perceive the positive energy of the body and mind, They listen to their inner hearts and experience the strength of meditation, To observe themselves and then support others people. The workshop have a rich content of meditation experience, four kinds of artistic environmental protection (mind, incense therapy, art, nature) inner experience, practice and spiritual communication, etc. cross over the concept and practice with exchange and discussion, so that participants can not only improve themselves at the physical and mental level, share and experience art and meditation process with each other, but also relieve the pressure of life, and find a personal spiritual .The Mindfulness workshop was successfully held on June 12, 27, July 3 and October 1, 2021 with the blessings of peace, joy and care. Thanks to everyone who attended the 4 workshops with 20 participants and 2 volunteers, 2021 Mindfulness Workshops partially supported the Nepal Women's Self-Reliance Project with a total of HKD2200</p> <p>舉辦靜心工作坊的目的，就是期待每位參與者覺察身心正能量，傾聽自己內心，體驗靜中得力，觀照自我進而影響他人。工作坊內容包括禪修體驗、四種藝術環保(心靈、香療、藝術、自然)直接體驗、實務與心靈交流等等豐富課程，觀念與實踐並行，搭配交流與討論，讓參加成員不僅可以在身心層面提昇自我，彼此分享體驗藝術及靜觀過程中也能舒解都市生活的壓力，尋找個人的心靈綠洲。</p> <p>靜心工作坊分別於2021日6月12,27日,7月3日,10月1日在充滿平安、喜樂、呵護的祝福下圓滿順利舉辦。衷心感謝每一位出席參與傳遞愛的力量給4次工作坊共有20名參加者及2名義工的參與，2021年度靜心工作坊部份收益支持尼泊爾婦女自力更生項目共HKD2200</p>



## 翳,化,藝(靜心工作坊)

不一樣的藝術體驗. 不一樣的心之旅行

藝術創作中的植物 自然的文藝復興

…… 我了解到 遵循自然的原始樣貌是最好的做法因為「簡單」就是藝術中最了不起的裝扮。----阿布雷希特·杜勒

~用花鼓打開心翳的世界, 趟開歡心之旅程, 請自己照好自己的心, 不要忘記, 一切都是緣起, 如願的, 不如願的; 喜歡的, 不喜歡的, 都是無常, 這些在人生旅程中, 從來不缺席; 無常, 其實很平常, 就用平常心, 面對平常事。

~用高原的野花直接沖熱水就能做成花茶, 待在靜謐的茶壺裡, 隨著植物感受季節和空間帶來的微妙變化, 心安此處, 眼裡看到的都是風景。

~用自然角度出發設計一個獨特的花藝創作, 用心的視野來構圖, 用四季花草來安排, 用植物與炭之色彩來作畫, 用美學生活來體驗。

~用喜愛的顏色跟著幻彩的變化, 每每都可在流動中裡發現流動的生命力, 真真實實地感受到自然樣貌與變化, 是一件多有趣的事呀!

我們相信真善美存在於人生旅程中, 只要你稍微敏銳一點去感知, 是時候展開你的感官之旅, 去體會那些能跟你共鳴的人、事、物, 或是觀感、想法與體會。





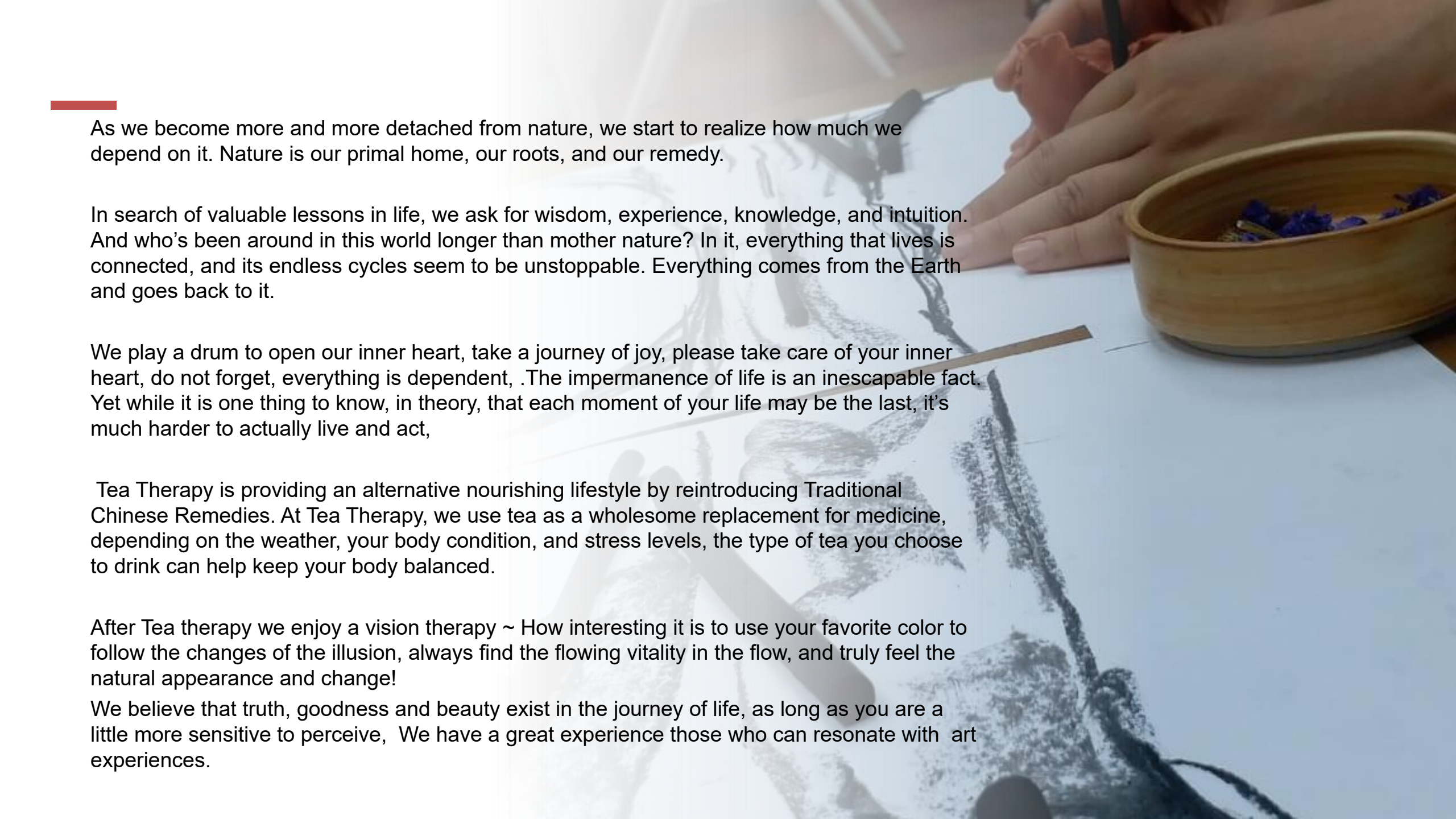

As we become more and more detached from nature, we start to realize how much we depend on it. Nature is our primal home, our roots, and our remedy.

In search of valuable lessons in life, we ask for wisdom, experience, knowledge, and intuition. And who's been around in this world longer than mother nature? In it, everything that lives is connected, and its endless cycles seem to be unstoppable. Everything comes from the Earth and goes back to it.

We play a drum to open our inner heart, take a journey of joy, please take care of your inner heart, do not forget, everything is dependent, .The impermanence of life is an inescapable fact. Yet while it is one thing to know, in theory, that each moment of your life may be the last, it's much harder to actually live and act,

Tea Therapy is providing an alternative nourishing lifestyle by reintroducing Traditional Chinese Remedies. At Tea Therapy, we use tea as a wholesome replacement for medicine, depending on the weather, your body condition, and stress levels, the type of tea you choose to drink can help keep your body balanced.

After Tea therapy we enjoy a vision therapy ~ How interesting it is to use your favorite color to follow the changes of the illusion, always find the flowing vitality in the flow, and truly feel the natural appearance and change!

We believe that truth, goodness and beauty exist in the journey of life, as long as you are a little more sensitive to perceive, We have a great experience those who can resonate with art experiences.



燃夢-半農半X種籽計劃

## 燃夢-半農半X種籽計劃

「藝術不是你所看到的,而是你讓別人看到的」, 協康會8名青年會員由社工王姑娘於2021年3月21,28及5月2日參與第二部份的「燃夢-半農半X種籽計劃」

第二部份的活動由資深義工太陽, 楠楠, 靜宜和根教授參加者一起創作縲布(SAORI),他們非常投入及享受體驗織布的過程,也是創辦人Misao Jo的格言:“所有的花都是美麗的,即使每朵花在形式和顏色上都不同。因為這種差異, ”一切都很好“。因為一切都有相同的生活,生活不能用標準來衡量。正是這種個性使一切變得有意義,每個線程的獨特性創造了生命的掛毯。參加者在二小時在花香義工太陽,楠楠,靜宜和根指導下完成了一幅獨一無二的「縲布」。

參加者除了織布外,大家在炎熱的天氣下,挑戰自己的耐力和毅力,一起共建「艾の天地」及「藝術磚」展開持續性的樸門農藝村落美學項目,同時探索大自然,一起環島認識坪洲海岸。

參加者在「燃夢-半農半X種籽計劃」的最後一天分享他們的感受,希望未來仍然有機會可以參與ArtêEco的義務工作活動,參加者的真摯分享感動了ArtêEco的成員,我們看到參加者那份對他人「真誠」,「善良」`「美麗」的心,期盼我們再有重聚的日子,燃亮我們的夢想,讓世界越來越美麗。



# Dreams - A Half Farmer and Seed Program

8 young members of Heep Hong Society, social worker Wang Girl, participated in the second part of the "Dreams - A Half Farmers and and Seed Project" on 21, 28 March and 2 May 2021

The second term of the event was created by senior volunteers Amy, Nannan, Jing Yi and Ne, who were very involved in and enjoyed experiencing the process of weaving, which was also the founder Misao Jo: "All flowers are beautiful, even if each flower is different in form and color." Because of this difference, "everything is fine". Because everything has the same life, life cannot be measured by standards. It is this personality that makes sense to everything, and the uniqueness of each thread creates of life. The participants completed a unique "Saori cloth" in two hours under the guidance of the IDLE volunteers Amy, NanNan, Jing Yi and Gen.

In addition to weaving, the participants challenged their endurance and perseverance in the hot weather to build the "Ai Tiandi" and "Art Brick" to carry out the ongoing Aesthetic Project of Permon Agronomic Village, while exploring nature and getting to know the coast of Peng chau together.

Participants shared their feelings on the last day of the "Dreams - Half Farmer Half and Seed Project", hoping that in the future there will still be opportunities to participate in ArtêEco volunteer work activities, They are sharing touched the members of ArtêEco, we saw the participants' "sincere", "kind" and "beautiful" hearts for others, looking forward to our reunion days, lighting up our dreams, and making the world more and more beautiful.







## Our Service (Nepal)

Item	Result
<p>Disaster Support Service Project Happiness Sunflower Handcraft Sustainable Project 尼泊爾災後支援服務計劃 Happiness Sunflower Handcraft sustainable Project</p>	<p>OWL (offerin Wisdom and Love) Home is a social enterprse.It has been set up for women afftected by earthquake on April 25. 2015 in Nepal. We believe concept of “Change your story, Change your life” that has been working to empower women at Chuchepati, Nepal. We encourage these women to self reliance, in order to upgrade their-confidence, social status and o improve their family income so that their children can go to school. Utimatly, we aim to spread the seed o hope and love in Nepal</p> <p>IDLE花香藝術館(慈善社會企業)透過自力更生的理念，給予了於2015年4月25日在尼泊爾受地震影響的婦女，從而【喚醒改變的力量，改寫她們的命運】，讓家庭收入生活穩定,孩子可以上學，將希望和喜樂的種籽散播在加德滿都</p>

**Disaster Support Service Project  
Happiness Sunflower Handcraft  
Sustainable Project  
尼泊爾災後支援服務計劃**





*Ever if 2021 was not good in the world. it still had its moments. and of course it was not good not for Nepal as well Strick lockdown was 3 times in 2021 in Nepal. Imposed lockdown is quite loosening up these days .*

*However ,the risk is there in Nepal. It is ongoing challenges of a global pandemic and all the changes that came with it. We are all excited to ring in a new year and hopefully, more normal days.*



- *We embrace new beginning, OWL Home also successfully completed year 2021. Even through all the insanity that was 2021, we managed to mark are happy to share that despite of the unusual situation our member Rekha Tamang continued hard working sewing Thaili Bags, Waterproof bags and package bags*
- *She is quite confident and matured in her work as she continues her work from the past years. She is also happy and proud because she is able to provide her daughter good education with her hard earned money. This year total of 1384 thaili bags ,166 Package bags and 473 waterproof bag sewing is completed.*
- *We would like to thank all the supporting hands, donors, well wishers for their contribution. With your support and blessings, OWL Home will continue to offer love and wisdom to Nepalese women.*





## Our Service (Nepal)

Item	Result
<p>Ankuran Waldorf Playspace Inspired School Project Progress Report 2021 種籽玩學谷華德福尼泊爾學校工程進度報告-2021年12月</p>	<p>種籽玩學谷華德福學校的信念是「給孤兒和街童一所學校，讓孩子健康快樂地成長」，讓尼泊爾的孤兒及貧困街童都享有平等獲得教育的權利。這裡不僅是一所學校，更是尼泊爾貧困街童、孤兒及受天災影響的兒童生命故事獲改寫的希望。學校的核心理念是「以人為本」，依據學生的發展階段，以其意志、情感、思考的發展需求為目標，令身體、心靈和精神平衡和諧發展，最終成為具創造力、道德感、責任感和獨立思維的人。</p> <p>Ankuran Waldorf Playspace Inspired School Project Progress Report - December 2021</p> <p>The belief of Ankuran Waldorf Playspace Inspired School is " We built and established Ankuran Waldorf Playspace Inspired School. We work closely with our local operational partner KRMEF to provide an inclusive and holistic education for 199 children aged between five and twelve through KRMEF. Most of these children are the first in their families to attend school. Our approach at KRMEF ensures that all students are supported to learn and develop a range of academic and life skills which will enable them to make choices about their futures.</p>



**Disaster Support Service Project  
Ankuran Waldorf Playspace Inspired  
School Project**

尼泊爾災後支援服務計劃  
種子華德福玩學谷尼泊爾學校

尼泊爾孩子的路，  
因你我而改變。  
讓風起了，  
夢飛翔。

## 種籽玩學谷華德福尼泊爾學校工程進度報告-2021年12月

種籽玩學谷華德福學校的信念是「給孤兒和街童一所學校，讓孩子健康快樂地成長」，讓尼泊爾的孤兒及貧困街童都享有平等獲得教育的權利。這裡不僅是一所學校，更是尼泊爾貧困街童、孤兒及受天災影響的兒童生命故事獲改寫的希望。

學校的核心理念是「以人為本」，依據學生的發展階段，以其意志、情感、思考的發展需求為目標，令身體、心靈和精神平衡和諧發展，最終成為具創造力、道德感、責任感和獨立思維的人。

### 一、校舍工程報告

種籽玩學谷華德福尼泊爾學校校舍營建工程，已完成整體結構工程。現正進行外牆及窗戶木作裝潢及穹頂靜修中心蓋建工程，學校預計明年九月完成。

計劃詳情



bit.do/eYv6x



尼泊爾建校計劃

讓街童和受地震影響的兒童上學去

籌款目標：港幣80萬

了解更多：<https://www.facebook.com/playspacehk>

尼泊爾孩子的路，  
因你我而改變。  
讓風起了，  
夢飛翔。



### 尼泊爾建校計劃

讓街童和受地震影響的兒童上學去

籌款目標：港幣80萬



了解更多：<https://www.facebook.com/playspacehk>

## Ankuran Waldorf Playspace Inspired School Project Progress Report - December 2021

The belief of Ankuran Waldorf Playspace Inspired School is "

We built and established Ankuran Waldorf Playspace Inspired School. We work closely with our local operational partner KRMEF to provide an inclusive and holistic education for 199 children aged between five and twelve through KRMEF. Most of these children are the first in their families to attend school. Our approach at KRMEF ensures that all students are supported to learn and develop a range of academic and life skills which will enable them to make choices about their futures.

Ankuran, which is the Nepali word for 'sprouting seed', is serving as a kindergarten and school for local children. We are looking to enrich the lives of the children through Waldorf inspired educational programs. We seek to nurture each child in our care so he or she may freely develop into a healthy, happy and wholesome human being. Through education, we also seek to prepare the children to meet society with self-confidence, critical thinking skills, and a sense of social responsibility. It is our hope they will use the skills and knowledge they will have gained here to serve the well-being of their community in the future.

Waldorf education is a unique and distinctive educational approach practiced in the largest group of independent, non-denominational private schools in the world. Waldorf schools offer a broad and balanced curriculum that is artistically structured to respond to the developmental needs of the children, so that the body, mind and spirit balance and harmonious development, and ultimately become a creative, moral, responsible and independent thinking people.

### 1. School Building Project Report

The construction of the school building of the Ankuran Waldorf has completed the overall structural works. The construction of the exterior wall and window wood decoration and the construction of the Dome Mediation centre is underway and is expected to be completed by September next year.

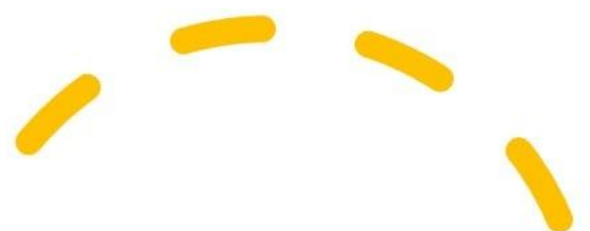

# Location of “ ANKURAN PLAYSPLACE WALDORF INSPIRED SCHOOL Map

School Site

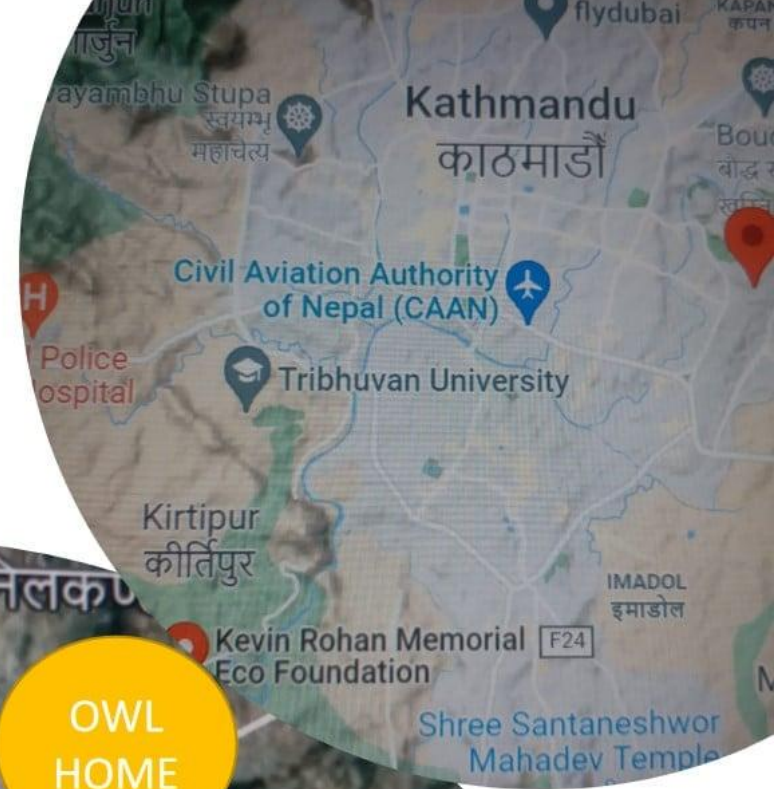
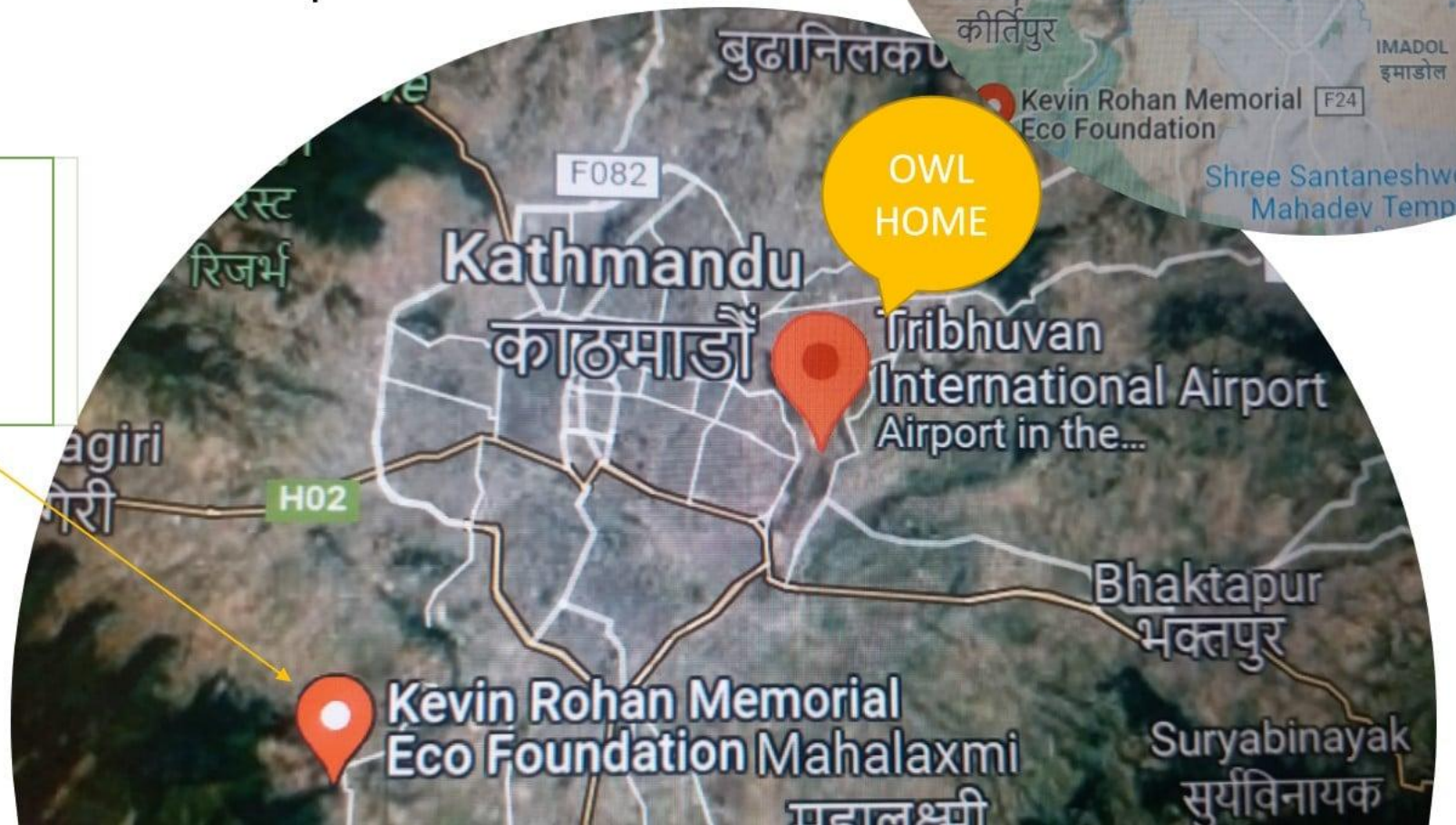





# ANKURAN PLAYSPACE WALDORF INSPIRED SCHOOL

## Construction Progress

*If we put our head, heart and hands in working for the community, anything is possible. Krishna Gurung (Founder of KRMEF)*

種籽玩學谷華德福學校(尼泊爾)建校進展實況

一所種籽華德福學校 籌建中



File School plan V3

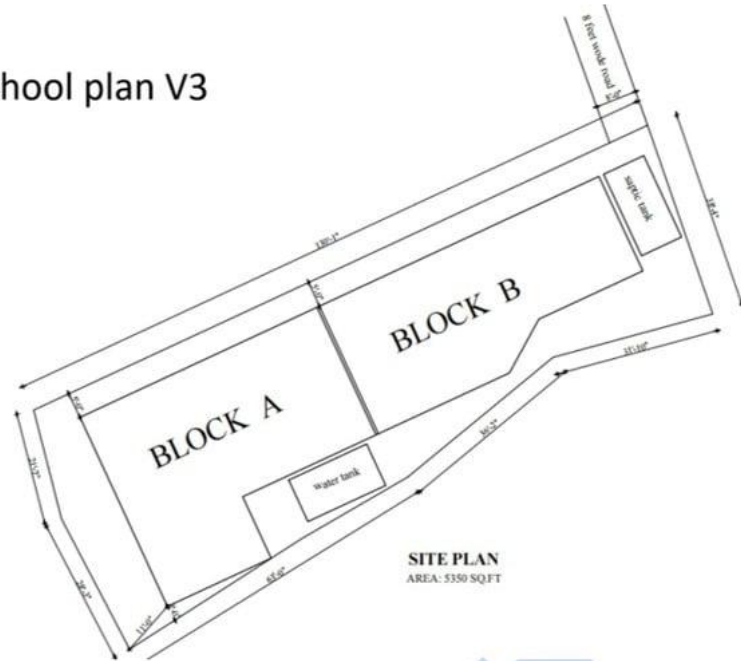

**BLOCK B**

# Ankuran Waldorf Playspace Inspired School



- The total student capacity for new building is 199 with 7 classrooms, of which 1 room is SAORI room for Playspace. We also have two classrooms in our own Bottle Building with the capacity of 30 children in each room. So even with 1 room used for Saori by Playspace, the total capacity of Ankuran Playspace Waldorf inspired school would be for 229 students.
- BLOCK B is Right side in this 3D picture

# Work in Progress (Pictures and description)

North West view Building "B"



North East view Building "B"





Work in Progress

Brick soling wok for the block "B"



Wall and window work Block "B".

# Measurement for Dome on the Block "B" rooftop



1. Existing column which is 4'



2. Addition of wall for the support

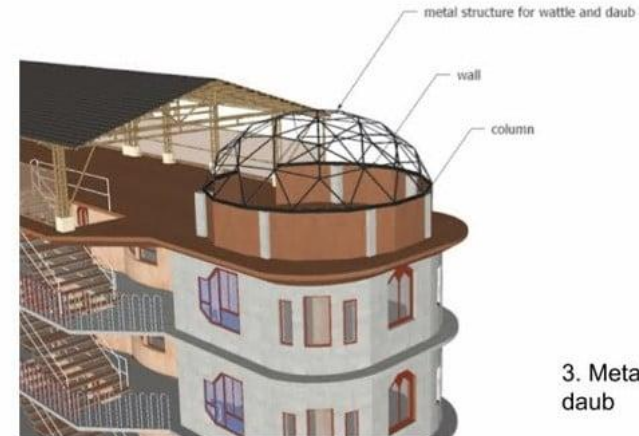

3. Metal framework to support the wattle and daub

*Sow a seed. Make a difference. Love connects us.*

## A SCHOOL, AN OPPORTUNITY BUILD A ROAD OF HOPE



**Nepal School Project**  
Target  
Underprivileged children  
Fundraising goal  
HK\$800,000



Construction of a primary school in Kathmandu  
(Ankuran Playspace Waldorf Inspired School)

About us : <https://www.facebook.com/playspacehk>

## Infinite Gratitude

Hand-in-Hand initiated by KRMEF Nepal and Hong Kong Playspace Charity Organization and IDLE FlowerArt Museum(Social Enterprise) with Fund raising aim at of HK\$1.78 million, Thanks a lot to the generosity of donation, a total of HKD \$1,125,793.93 has been raised from February 2018 at the end of April 2021, and part of the project has been disbursed total HKD\$1,171,225. on 16 September 2019 and 16 August 2021 respectively, Hong Kong Playspace Charity Organization has remitted HK\$520,000 to a KRMEF partner institution in Nepal to build a school project.

Thanks a lot for BFMF donation HKD 500,000 for the school construction project. Thank you to the Chairman of KRMEF for leading the staff to strictly control the quality of the construction. Thank you to Ms Eva Chan, she is a social worker in Macau, She kindly support to the Nepal school construction project in fundraising donations in Macau. We would like to thank Mr Keith Chan he is a volunteer engineer consultant of the Institution to provide professional advice on the school project. Thank you Little Half Studio Charity Bag Fundraising Project. Thank you all of the well-wishers who donation, All of your donations are your blessings and support for the street children and orphans in Nepal, your kindness heart gives us great encouragement. We will use it with caution to live up to your kindness! Thank you your kindness donation for this meaningful school project in Nepal. We will be a great encouragement to the institution and all the teachers and students of KRMEF Nepal! Thank you your kindness donation for this meaningful school project in Nepal. We will be a great encouragement for all the teachers and students of KRMEF Nepal!



*Sow a seed. Make a difference. Love connects us.*

## A SCHOOL, AN OPPORTUNITY BUILD A ROAD OF HOPE

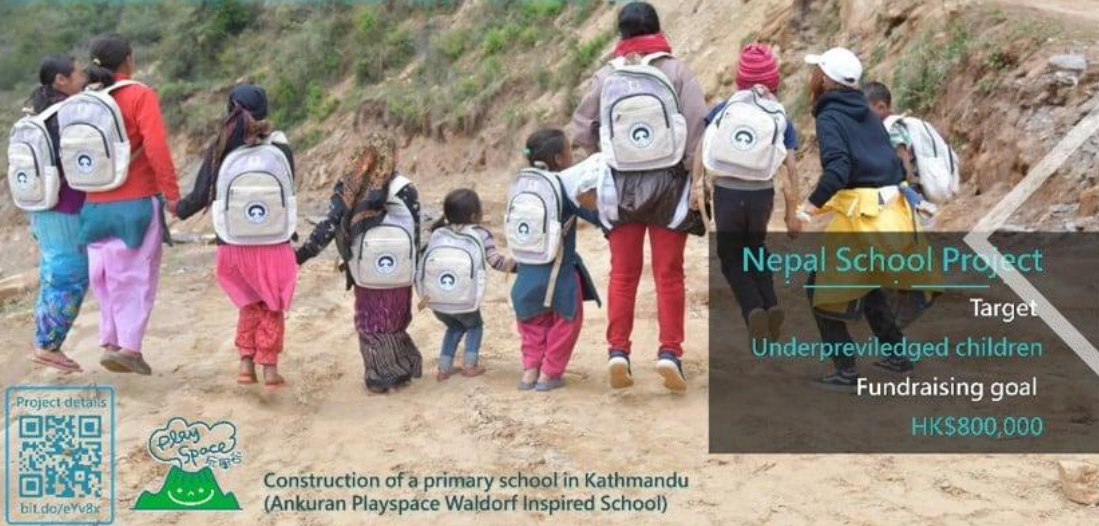

**Nepal School Project**  
Target  
Underprivileged children  
Fundraising goal  
HK\$800,000



Construction of a primary school in Kathmandu  
(Ankuran Playspace Waldorf Inspired School)

About us : <https://www.facebook.com/playspacehk>

## 無限感恩

由尼泊爾KRMEF和香港玩學谷慈善機構及IDLE花香藝術館聯合發起籌募建校目標為港元178萬港元，感恩善心人士的慷慨解囊，自2018年2月至2021年4月底為止，共籌款\$1,125,793.93元，已支出部分工程款共\$1,171,225元。香港玩學谷慈善機構已經分別於2019年9月16日及2021年8月16日匯款52萬港元到尼泊爾KRMEF合作伙伴機構營建學校工程。

感謝馮兆禹基金會捐款50萬作建校工程。感謝KRMEF主席率領員工，對施工品質嚴加把關。感謝澳門社工陳惠貞小姐全力支持尼泊爾建校工程於澳門展開籌募捐款活動。感謝本機構的義務工程師顧問陳曉滌先生，無私的支持提供工程書面監察建議。感謝小半工作室慈善背包籌款項目的支持。感謝所有捐款的善心人士，您的每一筆捐款，都代表著您對尼泊爾貧困街童及孤兒的祝福和支持，這給我們無比的鼓舞！我們將會審慎使用，以不辜負您的厚意！

近期多有善心人士，垂詢工程進度與所需費用，因茲簡報如上。鑑於全球疫情影響校舍營建工程費由原本開支預算為178萬港元，現通脹後修訂預算為2,320,269萬港元，凡有見聞者，無論是共襄盛舉，還是隨喜贊助，都將是本機構和全體尼泊爾KRMEF師生的莫大鼓勵！



# 誠邀您立即行動！

捐款方式：轉帳或劃線支票

機構名稱：玩學谷有限公司 (Playspace Limited)

慈善團體檔案編號：91/15075

捐款帳號：匯豐銀行 747-035640-838

東亞銀行 015-267-68-00550-6

捐款後請將入數紙連同姓名、聯絡電話，電郵至  
[playspacehk@gmail.com](mailto:playspacehk@gmail.com)

記錄和跟進，捐款港幣100元或以上可獲發免稅收據（僅香港居民適用）。

查詢：

電郵[playspacehk@gmail.com](mailto:playspacehk@gmail.com)

地址：香港荃灣大河道99號1803-04室



# We invite you support now.

Donation method: Transfer or crossed cheque

Support us : Playspace Limited

IRD File No : 91/15075

Please deposit into our

HSBC Bank Account: 747-035640-838

Bank of East Asia: 015-267-68-00550-6

Please mail, email to [playspacehk@gmail.com](mailto:playspacehk@gmail.com) the bank slip to Playspace. Please remark donors name, email address & contact phone number.

Record and follow up, donations of HK\$100 or above will be issued with a tax exemption receipt (for Hong Kong residents only).

Inquire

Email: [playspacehk@gmail.com](mailto:playspacehk@gmail.com)

Address : Units 03-04, 18/F., 99 Plaza, No. 99 Tai Ho Road, Tsuen



*2021.1 to 12  
Happiness Sunflower  
Hand Craft Project  
in Nepal*

Fund received from Jan to Dec 2021  
Balance Brought Forward(A) HK 87,060 +  
(B) 35,798- (C) HKD 47,138.9=(D) HKD75,719.1 Deflicit Balabce

NO	Name	HKD (Donation)	HKD (Selling)	Total
1	駱志恆( 1 至12月)	22000		22000
2	22/1/2021Little Half Studio selling : [小半X花香限量慈善義賣] 尼泊爾麻質背包 (平頂咖啡色款)HK330*1=HK330 (2/2021 Hong Kong)		330	330
3	6/2/2021台灣禪食堂西門店selling 4 capes HK1060		1060	1060
4	8/2/2021Selling 1 Cashmere capesHKD240 X 1 from ArteEco		240	240
5	capas		600	600
6	20.2/2021 Donation For Happiness Sunflower Handcraft sustainable project from 無名氏	200		200
7	黃楚瑩贊助網頁年費	160		160
8	L22/1/2021Little Half Studio selling : [小半X花香限量慈善義賣] 尼泊爾麻質背包 (平頂咖啡色款)HK330*1=HK330 (2/2021 Hong Kong)408 (4/2021 Hong Kong)		408	408
9	19.5.2021 棉衛生巾		100	100
10	9/5/2021 Donation For Happiness Sunflower Handcraft sustainable project from 無名氏	2000		2000
11	Cindy	1000		1000
12	Iren Yeung	100		100
13	蘇廬	5000		5000
14	澳門居民	2600		2600
	Total (B)	33,060	2,738	35,798

*2021.1 to 12*

*Happiness*

*Sunflower Hand*

*Craft Project*

*in Nepal*

Expenses from January 2021 to Dec 2021			
No	Categories	Amount in NRS	Amount in HKD
1	Rent	319,440.00	23000
2	Labor cost ( Owl Home Women wage, Project design fee ,selling commission charge, brand name fee, Volunteer Support Fee)	177,300	13,638
3	Program Material(Fabric, Label, Program material , Handcraft project, Selling Material , ARTECO)	1701	25.1
4	Donation to KRMEF	70,000	5000
5	Donation to Home Street Home project in Nepal	42000	3000
6	Support Owl Home Member Rekha Medical Fee	15000	1071.4
7	Office Expeses	19662	1404.4
	(C)	645,103	47,138.9

# Acknowledge 鳴謝

Innovation Design Life Educatin (IDLESocial Enterprise) sincerely thanks the following people and Organization. Thank you for your continued support and help so that we can provide appropriate services to those in need. (The rankings are in no order)

IDLE花香藝術館(社會企業)謹以摯誠向下列人士及團體，作衷心的感謝，感激大家去持續支持和幫助，使我們得以向有需要的人士提供適切的服務。(排名不分先後)

Foundation /Company Donatioin 基金會/公司  
Hong Kong (District)

馮兆禹先生基金會, 綠悠生活館, 蘇廬(大澳Solo Café) ,Little Half Workshop

Nepal(District)  
Kevin Rohan Memorial Eco Foundation (KRMEF),

# Acknowledge 鳴謝

Innovation Design Life Educatin (IDLESocial Enterprise) sincerely thanks the following people and Organization. Thank you for your continued support and help so that we can provide appropriate services to those in need. (The rankings are in no order)

IDLE花香藝術館(社會企業)謹以摯誠向下列人士及團體，作衷心的感謝，感激大家去持續支持和幫助，使我們得以向有需要的人士提供適切的服務。(排名不分先後)

## Personal Donation 私人贊助

### Hong Kong (District) 香港

Elane Chow ,Winnie Lo,Kathy Chan,Vivian Tse, Eva Tam,Dilys 周靈軒, 駱智恆 黃楚瑩 劉偉豪 ,曹亮伉儷, Widnes

### Macau (District)

蘇慕潔

### Japan (District)

Masayuki Family



# Acknowledge 鳴謝

Innovation Design Life Educatin (IDLESocial Enterprise) sincerely thanks the following people and Organization. Thank you for your continued support and help so that we can provide appropriate services to those in need. (The rankings are in no order)

IDLE花香藝術館(社會企業)謹以摯誠向下列人士及團體，作衷心的感謝，感激大家去持續支持和幫助，使我們得以向有需要的人士提供適切的服務。(排名不分先後)

Website establishment and management volunteers 網站建立及管理網站義工  
Fishnet studio Ltd , 謝昀華

Project Participant Volunteer 計劃參與義工

## Hong Kong 香港

Amy Tsang, Carey Wong, Chan Ching Yee, Charles Chow, David Chow, Dilys Yau Family , Eva Chan, Eva Tse, Eva Tam, Elane Chow, Helen Lam, Kathy Chan, Kora Liu , Kelvin Tang , Maggie Cheung, Michael Ng, Vivian Tse, Ng pun lung, Raymond Ho, Sarina Lau, Eric Mak, Olga , Ken Wong, Elaine

## Macau 澳門

Eva Chan,

## Japan 日本

Masayuki Nakamura Family , 付欣弋

# Founder and Staff

## 創辦人與職員

Founder 創辦人名單 (四川三聖花鄉)	Founder 創辦人名單 (香港坪洲ArteEco)	職員(四川) Staff	Staff ( Nepal)
張綺雲 (四川)	周鈴(香港)	石本凱 (2011.12-2012.12)	Dolma Shepra ( 2017.5 ---)
馮轉屏(四川)	謝鳳婷(香港)	文婷婷 (2012.05-2013.12)	Sita Bardeya (2017.5---2019.1)
鄧惠馨(四川)	譚秋梅(香港)	魏敏 (2013.09-2014.08)	Radhika Magar (2017.5---2019.9)
吳新健(四川)	黃楚瑩(香港)	鄧麗 ( 2014.11-2017.12)	Rekha Tamang (2017.5---)
曹秋雯(四川)	曹秋雯(香港)	陳志能 (2016-9-2019.1.30)	



坪洲療癒之島



*Healing is an art  
It takes time,  
It takes practice,  
It takes love*